

NOTE- PERFORMANCE AS PER ISO 9906 GRADE-2B

PERFORMANCE CURVE OF 6HS15 @980 R.P.M

6HS15/Y/107156



HS RANGE

MODEL 6HS15	WORKING PRESS	16 bar
SIZE 200x150-372	TEST PRESS.	24 bar
TYPE-AXIALLY SPLIT CASE SINGLE STAGE		SPEED 980 rpm
		DATE - 06.10.2022

SHADED REGION ON THE H-Q CURVE REPRESENTS OPTIMUM SELECTION ZONE

PUMP PERFORMANCE CHARACTERISTICS COMPUTED BASED ON CLEAN COLD WATER S.G 1.0

Max. Impeller Dia.	372mm
Min. Impeller Dia.	298mm
Impeller Drg. No.	171G030P
Volute Drg. No.	171G010P
Hydraulic Data	
Eye Area 366cm ²	Throat Area 87.53cm ²
Impeller Width 34mm	No. of Vanes 6
Volute Construction - Single Volute	

Shaft : Gr-2

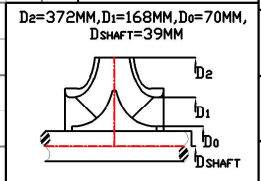

HEAD (M)

HEAD (FT)

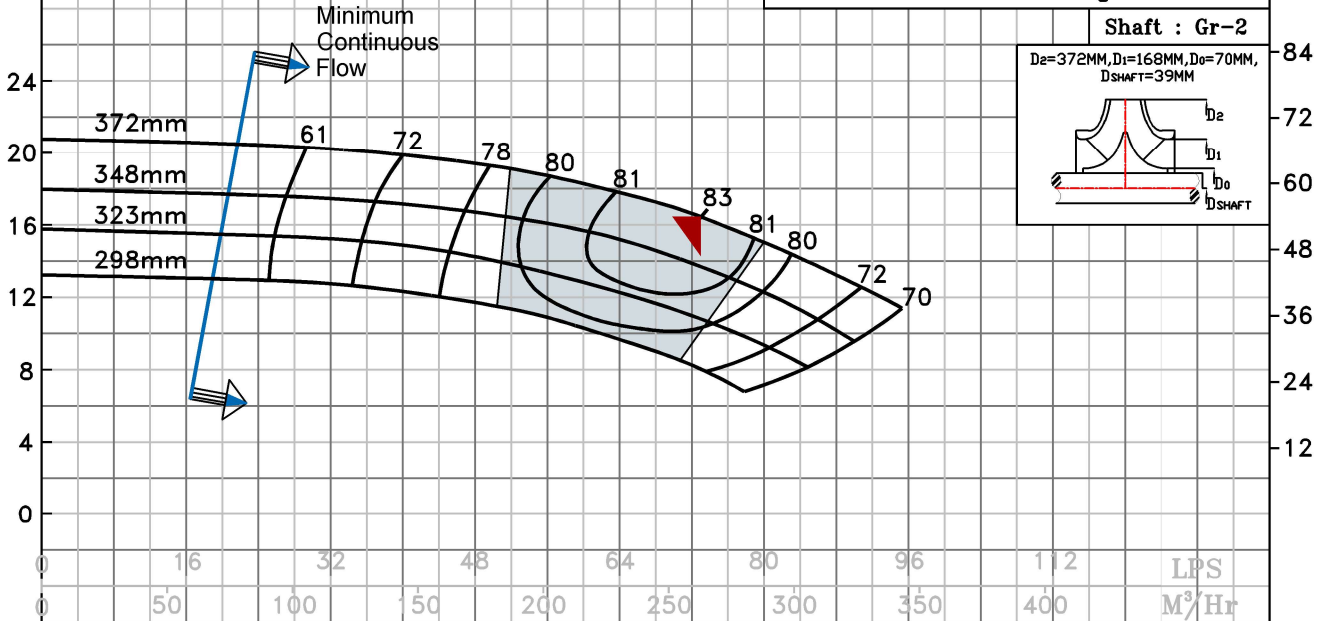

NPSHr (M) (FT)

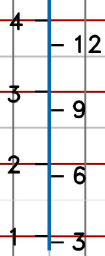

B.E.P Flow	262.9 M ³ /Hr.
B.E.P Head	16.5 M
Speed	980 R.P.M
Ns	1672 US UNITS

POWER (kW)

POWER (HP)

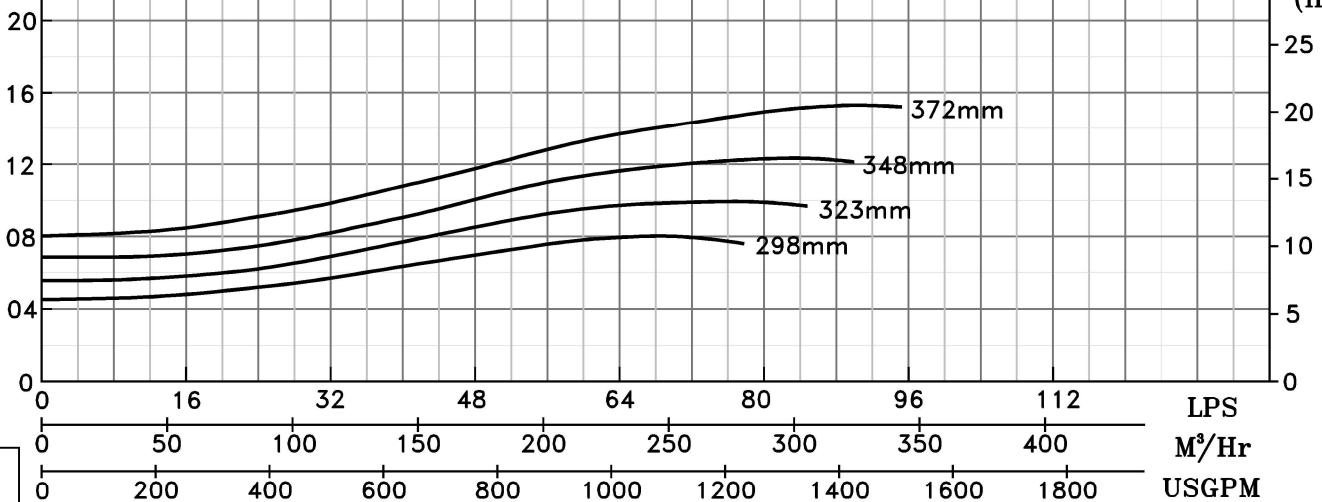

980 RPM