

NOTE- PERFORMANCE AS PER ISO 9906 GRADE-2B

PERFORMANCE CURVE OF 5HS17 @1765 R.P.M

5HS17/Y/101564



HS RANGE

MODEL 5HS17	WORKING PRESS. 16 bar
SIZE 150x125-440	TEST PRESS. 24 bar
TYPE-AXIALLY SPLIT CASE SINGLE STAGE	
SPEED 1765 rpm	
DATE - 06.10.2022	

SHADED REGION ON THE H-Q CURVE REPRESENTS OPTIMUM SELECTION ZONE

PUMP PERFORMANCE CHARACTERISTICS COMPUTED BASED ON CLEAN COLD WATER S.G 1.0

Max. Impeller Dia.	440mm
Min. Impeller Dia.	335mm
Impeller Drg. No.	115G030P
Volute Drg. No.	115G010P
Hydraulic Data	
Eye Area 302.7cm ²	Throat Area 68cm ²
Impeller Width 23mm	No. of Vanes 5
Volute Construction - Single Volute	
Shaft : Gr-2	

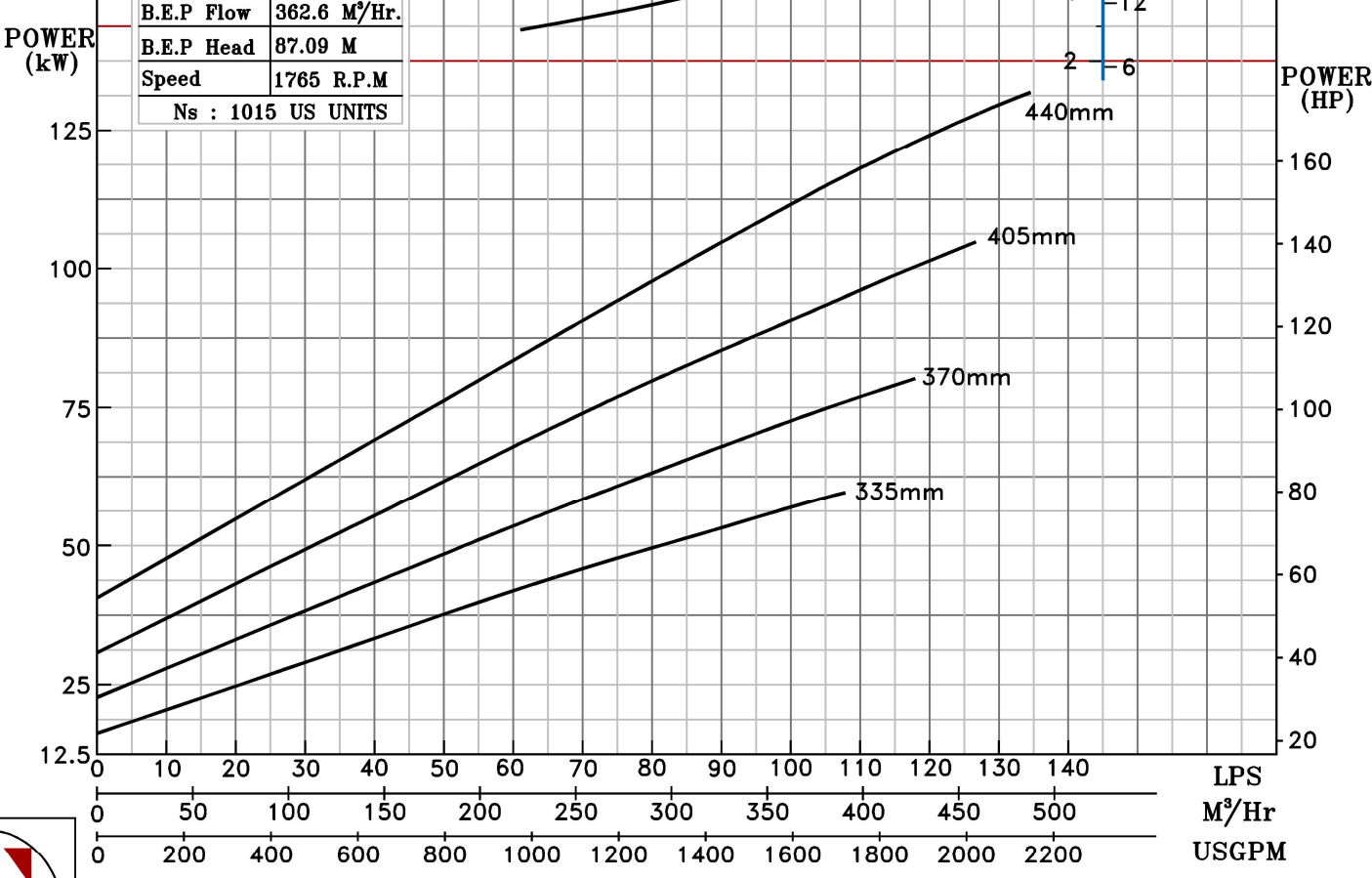
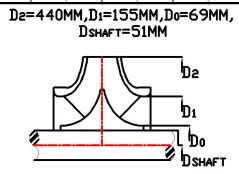
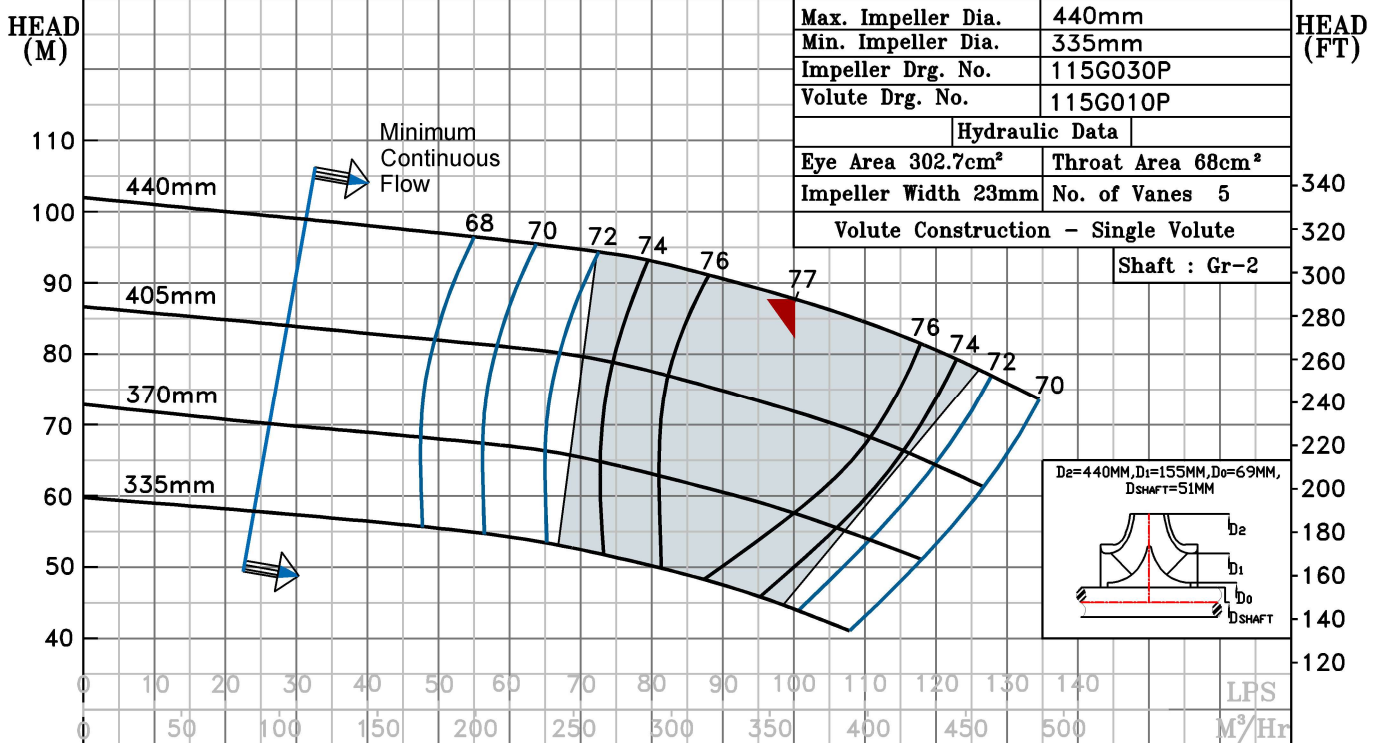

B.E.P Flow	362.6 M ³ /Hr.
B.E.P Head	87.09 M
Speed	1765 R.P.M
Ns : 1015 US UNITS	



1765 RPM