

NOTE- PERFORMANCE AS PER ISO 9906 GRADE-2B

PERFORMANCE CURVE OF 10HS17 @1480 R.P.M

10HS17/Y/103654



HS RANGE

MODEL 10HS17	WORKING PRESS. 16 bar
SIZE 300x250-440	TEST PRESS. 24 bar
TYPE-AXIALLY SPLIT CASE SINGLE STAGE	
SPEED 1480 rpm	
DATE - 06.10.2022	

SHADED REGION ON THE H-Q CURVE REPRESENTS OPTIMUM SELECTION ZONE

PUMP PERFORMANCE CHARACTERISTICS COMPUTED BASED ON CLEAN COLD WATER S.G 1.0

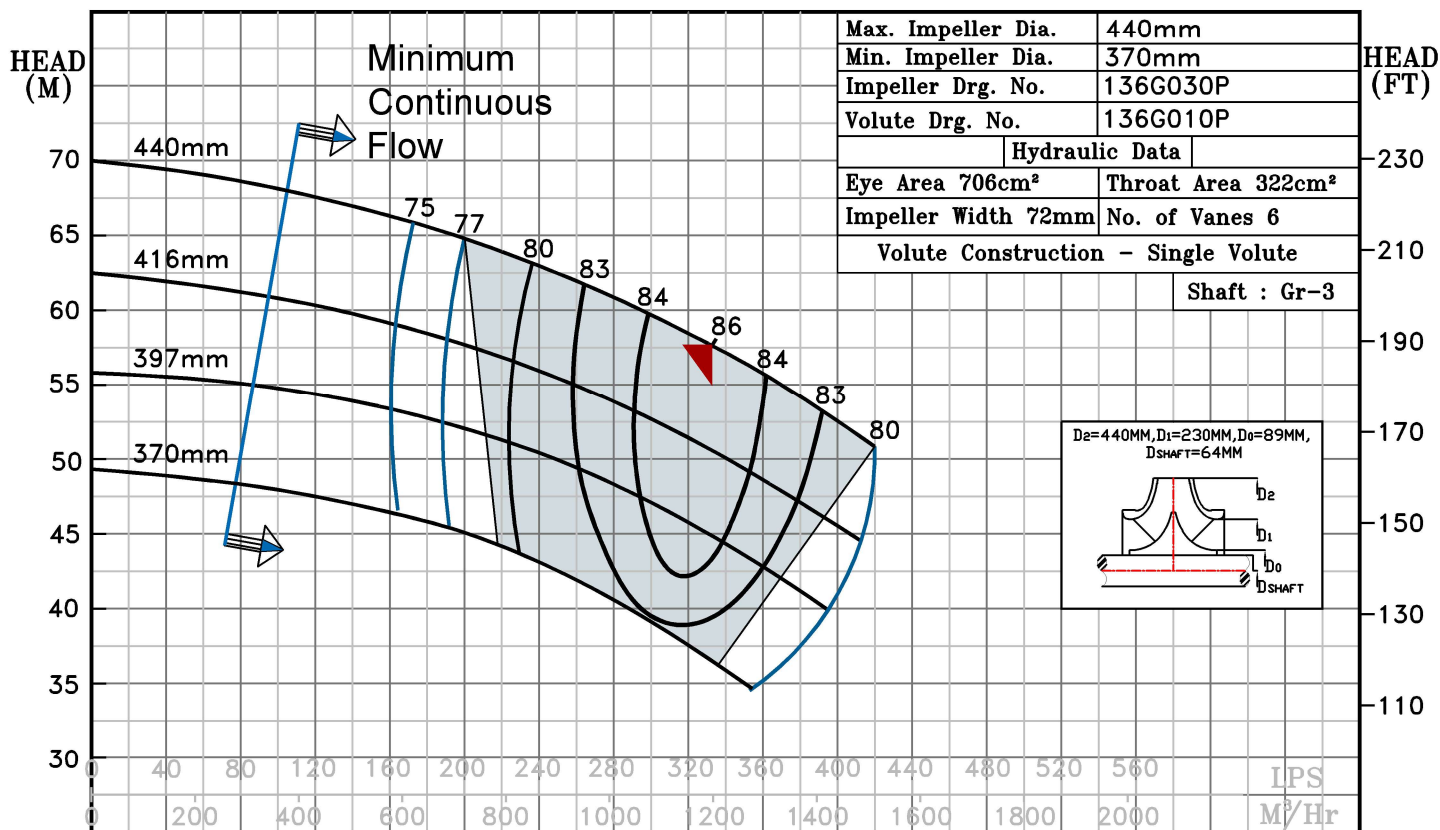

Max. Impeller Dia.	440mm
Min. Impeller Dia.	370mm
Impeller Drg. No.	136G030P
Volute Drg. No.	136G010P
Hydraulic Data	
Eye Area 706cm ²	Throat Area 322cm ²
Impeller Width 72mm	No. of Vanes 6
Volute Construction - Single Volute	
Shaft : Gr-3	

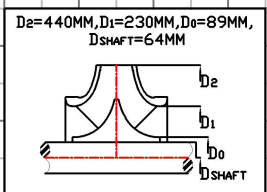

B.E.P Flow	1200 M ³ /Hr.
B.E.P Head	57.7 M
Speed	1480 R.P.M
Ns	: 2108 US UNITS

NPSHr	(M) (FT)
8	24
6	18
4	12

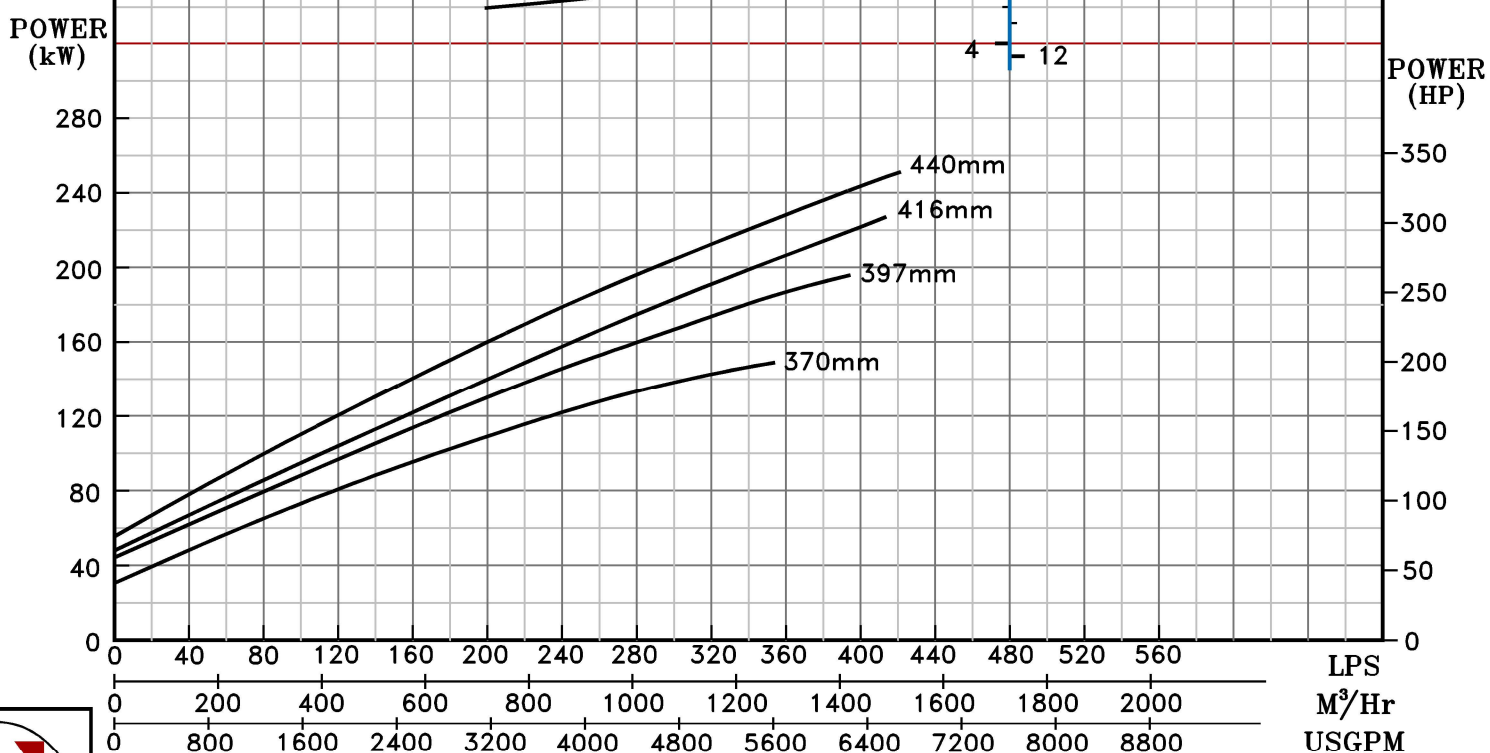

1480 RPM